



مدرسة جيمس متروبول الواحة  
GEMS Metropole School  
AL WAHA

*Parent*  
**NEWSLETTER**

Volume 01 | Issue 08 | 2023 - 24



Dear Parents,

Welcome to the eighth edition of our school newsletter! In this issue, we have some important reminders and updates to share with you.

Firstly, we would like to remind you that the Meet the Teacher event will be taking place on August 28th. This is a great opportunity for you to meet your child's teacher and familiarise yourself with the school environment.

As we prepare for the start of the school year, we wanted to provide you with more information on what to expect during the first week. Topics covered in this newsletter include the school day timings and meet the teacher emails, uniform guidelines, catering by Slices, school houses, device requirements and classroom cubby's for the children and more.

Uniforms are an essential part of our school's identity, and we believe that they promote a sense of unity and pride among students. Details on where to purchase the uniform, along with the reasons behind our uniform policy, can be found in this issue.

We are delighted to announce that we will be partnering with Slices for school catering. Slices specializes in providing wholesome and nutritious meals, and their mission aligns with our goal of educating students on healthy eating habits.

You will be receiving information about the school houses and we have lots of exciting things planned. We will also be asking the children to put their ideas forward for what they think we should call the houses.

Also included are some updates on devices. So make sure you look out for that page!

We hope that this newsletter will help you and your child have a successful start at GEMS Metropole Al Waha. With all the necessary information at hand, you can look forward to a memorable and enriching first week at school.

Thank you for your continued support, and we look forward to seeing you at the Meet the Teacher event.

Sincerely,

Jeremy Hallum



# Meet the Teacher & First Week at School

We are excited that it's almost time to welcome you for your first day at school.

On Monday 21st August every enrolled family should receive an email containing a booking link for you to make your appointment to come and meet your child/children's class teacher.

This is a short meeting with your class teacher, and for our Secondary students, their form teacher. The children are of course welcome, but they do not need to be in their school uniform.

Please see the details below for the week's schedule.

Monday 28th August      8:00am - 3:00pm- Parent/Teacher Meetings.

Tuesday 29th August    **Blue & Yellow Houses Only**  
7:40am - 12:30pm (FS Students)  
7:40am - 3:00pm (Year 1 to 8)

Wednesday 30th August **Red & Green Houses Only**  
7:40am - 12:30pm (FS Students)  
7:40am - 3:00pm (Year 1 to 8)

Thursday 31st August    7:40am - 12:30pm (FS Students)  
7:40am - 3:00pm (Year 1 to 8)

Friday 01st September   7:40am - 11:30am (FS Students)  
7:40am - 11.30am (Year 1 to 8)

Week beginning Monday 4th September

7:40am - 12.30pm (FS Students)  
7:40am - 3.00pm (Year 1 to 8)

Normal school day timings

Whole School Theme Week (Based on Sustainability)

We are working with THREADS for your school uniform requirements.

It is important that you make your appointment with them as soon as possible to ensure they can provide you with all your uniform needs.

THREADS provide pre-booking slots for your convenience which give you the flexibility to select the time slots you prefer to visit the store and purchase your uniform requirements.

If you haven't already, please book your slot now and visit THREADS at Cityland Mall. (Near, Global Village)

Whilst we have had the pleasure of meeting you for your tours there have been a number of uniform enquiries we will summarise for you. If you have child specific questions, please email [pre\\_mtw@gemsedu.com](mailto:pre_mtw@gemsedu.com)

School shoes must be black leather – for all year groups, including FS.

Trolley bags are NOT allowed.

Rucksacks with school branding are not compulsory, you can use any you like.

Bookbags are now back in stock.

**Get your kids a new look for the new academic year.**

*Our uniform stores are ready to serve with quality uniforms to give your kids a brand new look for the academic year.*

**GEMS METROPOLE SCHOOL AL WAHA**

*threads*  
Dressing up the Future World Leaders

Uniforms of GEMS Metropole School - AL Waha will be available at the Threads retail store in  
• Cityland Mall - Dubai.

**PRE-BOOKING IS MANDATORY**

SHOP EARLY TO AVOID THE RUSH

**UNIFORMS AVAILABLE NOW**

**PRE BOOK NOW TO SAVE YOUR SLOT**

**STEP 1** Pre-book your Appointment to Visit the Store [www.threadsme.com](http://www.threadsme.com)

**STEP 2** Present your Appointment Confirmation (QR code)

**ONLINE ORDERING**  
To free up your time, please order online at [www.threadsme.com](http://www.threadsme.com)  
Orders will be delivered to your preferred address.  
5-8 working days will be required for the delivery during peak sale period (Aug-Sep).

**MADE TO MEASURE SERVICES**  
MTM will take 10 working days from the date of order.  
This service will be provided at **Cityland Mall** Outlet.  
**PRE-BOOK** your Made to Measure Service at [www.threadsme.com](http://www.threadsme.com).

*threads*

**FIRST UNIFORM BRAND TO INTRODUCE A VIRTUAL FITTING ROOM IN THE REGION.**

**MYSIZE ID**  
A quick and easy process that enhance your online shopping experience by instantly recommending your uniform size

**threads**  
Dressing up the Future World Leaders

FOLLOW US FOR THE LATEST PRODUCTS AND SERVICES

800-8473237(THREADS) [www.threadsme.com](http://www.threadsme.com)

# Slices

SLICES

CATERING

Starting from August 29th, SLICES will be open in school, offering a wide selection of food for purchase. We are delighted to have partnered with SLICES, as their goal aligns with our mission to promote healthy eating habits among our students along with their efforts towards sustainability and the impact we can have on the climate by the decisions we make.

SLICES not only provides nutritious meals but also educates our students about the importance of making wholesome food choices. By collaborating with SLICES, we are ensuring that our students have access to delicious and nourishing meals that will support their mental and physical growth throughout the day.

In addition to welcoming SLICES, we are also allowing students to bring packed lunches from home. We understand that children often enjoy bringing their favourite meals from home, and we want to encourage them to continue making mindful choices about their food.

Let's join hands in taking advantage of this new opportunity and empower our students to develop healthy eating habits that will benefit them for a lifetime.





## School Houses

There are many exciting things planned for the school houses.

Along with your child's class teacher information you will also be finding out (if you haven't already) what their school house is.

We have four colours representing the houses Blue, Yellow, Red and Green and once the children start school they will be given the opportunity to put forward their suggestions and to what we call them.

What would you call them?

**MTW HOUSE SYSTEM  
COMING SOON!!!**

Curriculum Champions  
House Competitions  
**Leaders**  
Olympiads  
Engagement  
Support  
Community Champions

E-Safety Leaders  
Learning Leaders  
Sustainability Leaders  
Wellbeing Leaders  
Shared Goals

Camaraderie  
Language Leaders  
Challenges  
Problem Solving

Inclusivity  
Quiz Bee  
Empathy  
Clubs  
Student Council  
Entrepreneurship

GEMS Metropole School  
AL WAHA

**iPads will NOT be required in FS.**

**iPads WILL be required from Year 1.**

We appreciate some parents have had reservations about children in FS being responsible for and using an iPad as part of their curriculum. Mr Hallum is listening to your feedback and has made the decision that iPads will not be required until Year 1.

All other students will need to have a device.

For the best performance of school-based application there is a minimum specification.

We all recommend for students in year 7 and 8 to incorporate a keyboard and stylus.

If you have any questions or feedback about devices, please forward them to [pre\\_mtw@gemsedu.com](mailto:pre_mtw@gemsedu.com) who will direct your query accordingly.

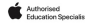
**jtrs** EDUCATION |  Authorized Education Specialist

 **GEMS Metropole School**  
Dubai

## Education Special Discounts





**Year 1 To 9**



**iPad 10th Gen**  
10.9 Inch Screen  
64GB & 256GB Available

64 GB	256 GB
<b>1,630</b>	<b>2,180</b>
<small>*Excluding VAT*</small>	<small>*Excluding VAT*</small>

**Accessories**

 <small>Apple Pencil</small> 355 AED	 <small>AppleCare+ for iPad</small> 230 AED	 <small>Logitech Combo Touch</small> 530 AED
 <small>E Safety Software Package for Apple Devices (Mandatory)</small> 200 AED	 <small>Case with Screen Protector Pen Holder</small> 90 AED	

**Purchase Guide**

BACK TO MAIN PAGE      www.jtrs.ae | 04 338 0990 | info@jtrs.ae  
\* Terms & Conditions Apply \*

Each student will be allocated their own space to store their belongings whilst in school.

FS1-Yr 2 will have pegs

Year 3 to Year 6 will be allocated a cubby

Years 7- Year 8 will be allocated a locker.

This space will enable each student to have a safe space to keep their belongings.

You may want to have a spare set of clothes at school for FS children, the cubby can be the place to keep them.

For the older students they may want somewhere to leave their bags when they go for lunch or head outside on their break.

For your convenience we are sharing the dimension to ensure that belongings can fit in the space allocated.

Cubby unit: 27.5 L x 44 D x 47 H cm

Locker : 27.5 L x 47 D x 55 H cm

**PLEASE ENSURE YOU PROVIDE YOUR YEAR 7/8 CHILD A PADLOCK FOR THEIR LOCKER**



When you have visited the school campus recently you will have noticed that work is ongoing on to improve the road outside school.

RTA are working very hard and are doing their utmost to have the road ready for when we open.

We politely ask for your patience with them and us and we work to make your experience as easy as possible.

Whilst we navigate the infrastructure on the first days of school we understand that there may be slight delays for people and we will take this into consideration should you arrive late for class.



Many of you have been asking where the drop off points will be, and we want to share that with you. When you have your Meet the Teacher session, they will also be able to help you with any further questions.

Each entry point will have a member of staff checking in the children and making sure they find their way happily to their classroom. If you need any assistance, please contact us.

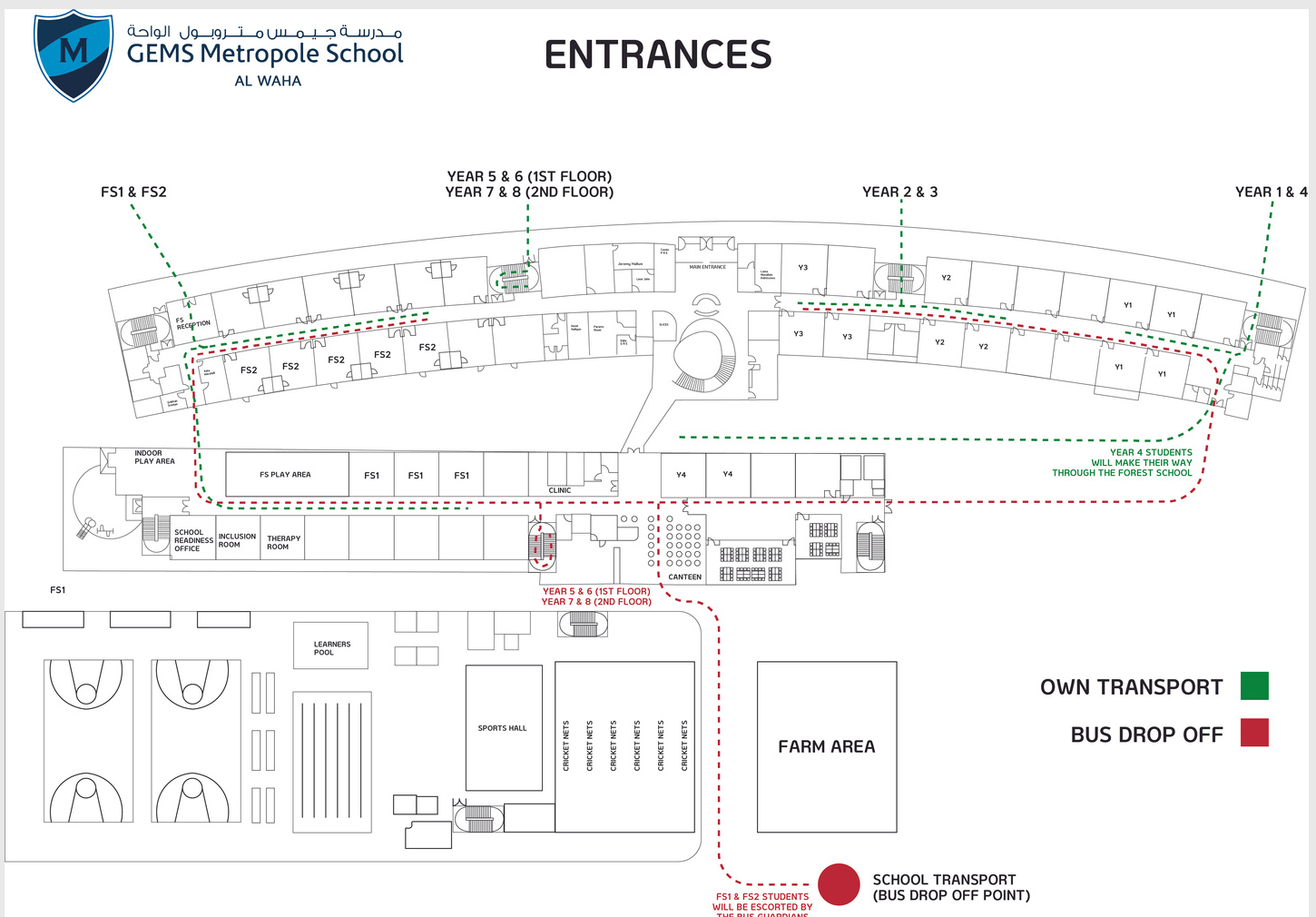



Some of the memories made with our #MTWFamily this week

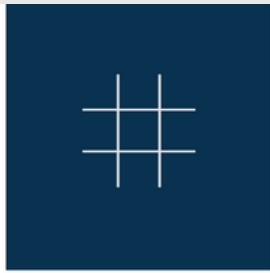

ANY

QUESTIONS

Please click on the link below to share your question with us or scan the QR code below



<https://forms.office.com/r/2S07fzs4LV>

Inevitably there will be questions that you as parents have when joining a new school. To support in this matter each newsletter we will endeavour to clarify anything you need to know. Please populate the link with any questions that you have and we will do our best to reach out to you & address your questions.





مدرسة جيمس متروبول الواحة  
**GEMS Metropole School**  
AL WAHA

*Nurturing*  
**LEADERSHIP**